

PrO-Analytical

By Centurion Scientific Ltd



25 years of
Excellence

Benchtop Centrifuges

Welcome to our new PrO-Analytical range.

Designed by an Analytical Chemist and Laboratory Scientists, we offer state of the art and best value centrifuges for Analytical and General purpose use. Derived from our LED display centrifuges spanning over 25 year's of Centrifuge manufacturing.

Ambient

Designed to keep sample heating to a minimum, our **"Through flow air system"** is unsurpassed.

Thus keeping not only the samples cool, but the motor too, allowing , if necessary, long run times.

Feature count is the best for your various needs

Refrigeration

Our Latest **"Dynamic efficiency control system"** in LED display format derived from our long running LCD series is now available to meet the needs of the market. Our aim with all our Refrigeration Systems was to reduce power by 25% and was easily achieved. New thicker stainless bowls and improved heat exchanger, with larger, yet more efficient compressors and condensers.

Our control is unsurpassed, by using the compressor's hot by pass gas, against its own cooling we can control to levels beyond our competitors, who simply switch the fridge on and off.

A new, next generation PID control software system adds to the control too. A body redesign has resulted in a simple access panel , should any Mains voltage control parts need servicing.

Rotors

We are aware of the needs of longevity and the need for corrosive or chemical resistance is paramount. **NOTE** all bowls in the Centrifuges are Stainless steel (Salt saturation tested)

To this end our fixed angle rotors are CNC machined from polypropylene as are the adaptors.

Giving the best strength and chemical resistance for your needs.

Our swing out rotors and high speed rotors are made from aircraft grade high strength aluminium and then double anodised for protection.

As a manufacturer we are aware of your different needs, if you have such requests. Please call us, If possible we can specialise or add a rotor from another range to assist.

From the start of 2014 all Centrifuges and rotors carry a 3 year warranty

That is how confident we are of our quality and resilience

Please see our specifications on our features page for more information on this range

Centurion Scientific Ltd

PrO-Analytical Centrifuges

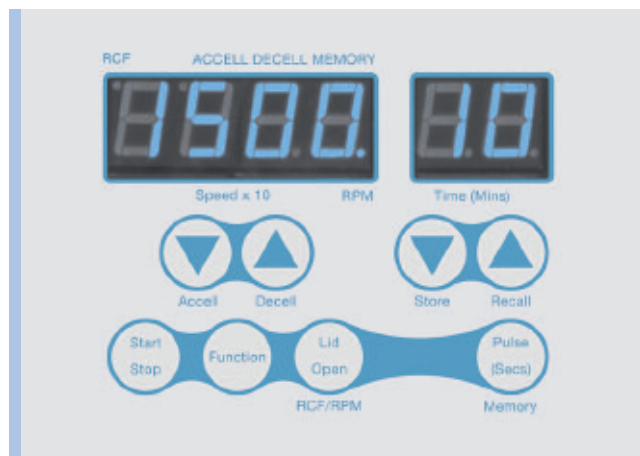

Built to last, strong construction yet offering a sleek modern design that will fit into any modern laboratory.

No compromises on quality, only the best components are used in the manufacturing process.

By working with all our suppliers, our reliability has been retained and improved to give all our range a **3 year warranty** as standard.



CE marked and ISO 9001 regulated and now IVD certified too

User features to PrO-Analytical series	Advantages
Bright blue LED display	Clarity & ease of use
Rotor recognition CR2000, CR4000/R and CR7000/R only	Safe selection of rotors
10 acceleration rates 10 deceleration rates	Sample assistance
10 memory	Multi users
Timer 0-99 minutes & Hold in 30 second increments	Total flexibility
Pulse short run	Fast pelleting
Run in Speed (Rpm) or Rcf (G) in 10 Rpm increments	Accuracy
Sound <60Db (rotor dependant)	Quiet
Orientation acceleration rate	Prevents initial sample side deposits
Refrigerated models PID controlled	Accuracy

Standard to PrO-Analytical series	Advantages
Extra thick Stainless steel bowl	Easy clean & rust free
Port to lid	Tachometer speed certification
Alloy & steel frame with composite's	Strong light & quiet
World leading Industrial grade Inverter	Reliability & strength
Best Quality European Brushless motor	Quiet, cool & reliable
High technology airflow (ambient models)	Cooler running
All centrifuges have user accessible service sections to access all safety parameters	

Safety features to PrO-Analytical series	Advantages
Multi point lid locking	Lid safety & ease
Emergency lid release	Power failure release
Lid gas struts	Lid dropping safety
Lid lock detection	To run Lid must be shut
Imbalance detection	Easy "eye" volume loading
Overspeed Sensor	Safe detection of speed
Set inverter values	Electronic safety of speed
Barrier ring	Extra metal protection of chamber
Motor overheat sensor	Safe motor protection

Centurion Scientific Ltd centrifuges comply to all relevant EU standards for Quality and medical Devices IEC 61010 and CE conformity test marks Emission, immunity to EN/IEC 61326-1, Class B

Index

- Page 5** C1006 Small Centrifuge
6000 Rpm, 3500 Rcf(G) 8 x 15ml and 4 x 4 fixed angle
- Page 6** C2012 Haematocrit / Micro Centrifuge
12000 Rpm, 13500 Rcf(G) Haematocrit and micro 24 x 2ml
- Page 7** C2015 Micro Centrifuge
15000 Rpm, 22000 Rcf(G) Four types of Micro rotors
- Page 8** C2004 Medium Centrifuge 400ml
4000 Rpm, 2200 Rcf(G) Swing out & Fixed angles
- Page 9** C2006 General Purpose
6000 Rpm, 3800 Rcf(G) Fixed angle to 6 x 50ml
- Page 10** CR2000 Multi Purpose 400ml
12000 Rpm, 13500 Rcf(G) Multiple rotors Rotor recognition system
- Page 11** Rotors available to CR2000
Swing out rotor 4 x 100ml Micro rotors Large fixed angle
- Page 12** CR4000 and CR4000R 1 litre centrifuge
15000 Rpm, 22000 Rcf(G) Multiple rotors Rotor recognition system
- Page 13** Rotors available to CR4000/R
Swing out rotor 4 x 250ml Micro rotors
- Page 14** Rotors available to CR4000/R
Large fixed angle rotors
- Page 15** Temperature Control Data
- Page 16** CR7000 and CR7000R 3 litre centrifuge
6000 Rpm, 4800 Rcf(G) Multiple rotors Rotor recognition system
- Page 17** Rotors available to CR7000/R
Swing out rotor 4 x 750ml Micro rotors
- Page 18** Rotors available to CR7000/R
Large fixed angle rotors
- Page 19** Adaptors available to all

NOTE: Other Rotors in our range can be used, available upon request.

C1006 Small Centrifuge



Display indicative only.

- Speed**500-6000 Rpm
(10 Rpm steps)
- Rcf max**3,500 G
- Timer**.....0-99 Mins & hold
(30 sec steps)
- Dims HWD**235 x 235 x 350mm
- Weight**.....12.8 Kg (without rotor)
- Power**.....172 watts
- Memory**.....10 programs
- Accel rates** ...10 programs
- Decel rates** ...10 programs

Fixed Angle Rotor to 15ml



Rotors

	BRK5407	BRK5408
Rotor type	4 x 15ml & 4 x 10ml	8 x 15ml
Tube size max	17 x 120mm & 13x 110mm	17 x 120mm
Minimum speed	500 Rpm	500 Rpm
Maximum speed	6000 Rpm	6000 Rpm
Maximum Rcf (G)	3500	3500
Radius max cms	8.50	8.50
Sample tube angle (o)	30	30
Acceleration time (secs)	30	30
Deceleration time (secs)	30	30
Autoclaveable (frequency)	121°C (10)	121°C (20)

C2012 Haematocrit Centrifuge



Display indicative only.

- Speed** 500-12000 Rpm
(10 Rpm steps)
- Rcf max** 13,500 G
- Timer** 0-99 Mins & hold
(30 sec steps)
- Dims HWD** 235 x 235 x 350mm
- Weight** 12.8 Kg (without rotor)
- Power** 172 watts
- Memory** 10 programs
- Accel rates** ... 10 programs
- Decel rates** ... 10 programs

Haematocrit & Microtube rotor



NEW
High dome sealed
Polycarbonate lid
included

Rotors

	BRK5401	BRK5424
Rotor type	24 x Capillary & 12 x 2ml	24 x 2ml
Tube size max	2 x 75mm & 11 x 40mm	11 x 50mm
Minimum speed	500 Rpm	500 Rpm
Maximum speed	12,000 Rpm	12,000 Rpm
Maximum Rcf (G)	13500	13500
Radius max cms	8.5	8.75
Sample tube angle (o)	0 & 60	45
Acceleration time (secs)	30	20
Deceleration time (secs)	30	20
Autoclaveable (frequency)	121°C (10)	121°C (20)

Accessories



8003 PCV reader



8014 Sealing clay

Part Number	Description
8012	Plain Capillary tubes pack 1000
8013	Heperanised Capillary tubes pack 1000

C2015 Microtube Centrifuge



Display indicative only.

- Speed** 500-15000 Rpm
(10 Rpm steps)
- Rcf max** 22,000 G
- Timer** 0-99 Mins & hold
(30 sec steps)
- Dims HWD** 235 x 235 x 350mm
- Weight** 12.8 Kg (without rotor)
- Power** 172 watts
- Memory** 10 programs
- Accel rates** ... 10 programs
- Decel rates** ... 10 programs

Microtube Rotors 15,000 Rpm

NEW
High dome sealed
Polycarbonate lid
included



Rotors	BRK5424	BRK5436	BRK5448	BRK5494
Rotor type	24 x 2ml	36 x 0.5ml	48 x 0.2ml	4 x Pcr strips
Tube size max	11 x 50mm	8 x 30mm	6 x 40mm	8 per strip
Minimum speed	500 Rpm	500 Rpm	500 Rpm	500 Rpm
Maximum speed	15,000 Rpm	15,000 Rpm	15,000 Rpm	15,000 Rpm
Maximum Rcf (G)	22000	22000	22000	22000
Radius max cms	8.75cms	8.75cms	8.75cms	8.75cms
Sample tube angle (o)	45	45	45	45
Acceleration time (secs)	20	20	20	20
Deceleration time (secs)	20	20	20	20
Autoclaveable (frequency)	121°C (20)	121°C (20)	121°C (20)	121°C (20)

Reducers

Rotor	BRK5424
Part number Pack 24	RS04 (0.2 - 0.4ml)
Tube size max	6 x 30mm
Part number Pack 24	RS05 (0.5ml)
Tube size max	8 x 30mm



C2004 Medium Centrifuge



Display indicative only.

- Speed**500-4000 Rpm
(10 Rpm steps)
- Rcf max**2200 G
- Timer**.....0-99 Mins & hold
(30 sec steps)
- Dims HWD**275 x 325 x 470mm
- Weight**.....21.8 Kg (without rotor)
- Power**.....125 watts
- Memory**.....10 programs
- Accel rates** ...10 programs
- Decel rates** ...10 programs

Rotors 4000 Rpm

Swing Out Rotors

Adaptors required see page 19



Rotors	BRK5431	BRK5434
Rotor type	24 x 15ml	8 x 50ml
Tube size max	17 x 120mm	30 x 120mm
Minimum speed	500 Rpm	500 Rpm
Maximum speed	4,000 Rpm	4,000 Rpm
Maximum Rcf (G)	2200	2200
Radius max cms	12.3	12.3
Sample tube angle (o)	30	30
Acceleration time (secs)	35	35
Deceleration time (secs)	35	35
Autoclaveable (frequency)	121°C (20)	121°C (20)

Rotor	BRK5505
Rotor type	4 x 100ml
Tube size max	45 x 100mm
Minimum speed	500 Rpm
Maximum speed	4,000 Rpm
Maximum Rcf (G)	2200
Radius max cms	12.3
Sample tube angle (o)	0
Acceleration time (secs)	25
Deceleration time (secs)	25
Autoclaveable (frequency)	121°C (20)

Sealed lids available set 4 Part Nos 5419

Reducers



Rotor	BRK5431	BRK5434
Part number	RM05 (5ml)	RM15 (15ml)
Tube size max	13 x 80mm	17 x 120mm
Part number	RM10 (10ml)	RM25 (25ml)
Tube size max	16 x 100mm	25 x 100mm

C2006 General Purpose Centrifuge



Display indicative only.

- Speed**500-6000 Rpm
(10 Rpm steps)
- Rcf max**3,800 G
- Timer**.....0-99 Mins & hold
(30 sec steps)
- Dims HWD**275 x 325 x 470mm
- Weight**.....21.8 Kg (without rotor)
- Power**80 watts
- Memory**10 programs
- Accel rates** ...10 programs
- Decel rates** ...10 programs

Rotors 6000 Rpm



Rotors	BRK5412	BRK5406
Rotor type	12 x 15ml	6 x 50ml
Tube size max	17 x 120mm	30 x 120mm
Minimum speed	500 Rpm	500 Rpm
Maximum speed	6,000 Rpm	6,000 Rpm
Maximum Rcf (G)	3800	3800
Radius max cms	9.5	9.5
Sample tube angle (o)	30	30
Acceleration time (secs)	25	25
Deceleration time (secs)	25	25
Autoclaveable (frequency)	121°C (20)	121°C (20)

Reducers



Rotor	BRK5412	BRK5406
Part number	RM05 (5ml)	RM15 (15ml)
Tube size max	13 x 80mm	17 x 120mm
Part number	RM10 (10ml)	RM25 (25ml)
Tube size max	16 x 100mm	25 x 100mm

CR2000 Multi Purpose Centrifuge

Rotor Recognition - 4 x 100ml Max



Display indicative only.

- Speed**500-12,000 Rpm
(10 Rpm steps)
- Rcf max**13,500 G
- Timer**.....0-99 Mins & hold
(30 sec steps)
- Dims HWD**275 x 325 x 470mm
- Weight**.....21.8 Kg (without rotor)
- Power**.....175 watts
- Memory**.....10 programs
- Accel rates** ...10 programs
- Decel rates** ...10 programs

Swing Out Rotors

Adaptors required see page 19



Rotors	BRK5505	BRK5508M
Rotor type	4 x 100ml	8 x 10ml
Tube size max	45 x 100mm	15 x 115mm
Minimum speed	500 Rpm	500 Rpm
Maximum speed	4,000 Rpm	4,000 Rpm
Maximum Rcf (G)	2200	2200
Radius max cms	12.3	12.3
Sample tube angle (o)	0	0
Acceleration time (secs)	25	25
Deceleration time (secs)	25	25
Autoclaveable (frequency)	121°C (20)	121°C (20)

Rotors available to CR2000

Rotors High Speed



NEW
High dome sealed
Polycarbonate lid
included

Rotors	BRK5401	BRK5424
Rotor type	24 x Capillary/12 x 2ml	24 x 2ml
Tube size max	2 x 75mm/11 x 40mm	11 x 50mm
Minimum speed	500 Rpm	500 Rpm
Maximum speed	12,000 Rpm	12,000 Rpm
Maximum Rcf (G)	13500	13500
Radius max cms	8.5	8.75
Sample tube angle (°)	0/60	45
Acceleration time (secs)	25	20
Deceleration time (secs)	25	20
Autoclaveable (frequency)	121°C (10)	121°C (20)

Rotors Medium Speed



Rotors	BRK5412	BRK5406
Rotor type	12 x 15ml	6 x 50ml
Tube size max	17 x 120mm	30 x 120mm
Minimum speed	500 Rpm	500 Rpm
Maximum speed	6,000 Rpm	6,000 Rpm
Maximum Rcf (G)	3,800	3,800
Radius max cms	9.5	9.5
Sample tube angle (°)	35	35
Acceleration time (secs)	20	20
Deceleration time (secs)	20	20
Autoclaveable (frequency)	121°C (10)	121°C (20)

Reducers



Rotors	BRK5412	BRK5406
Part number	RM05 (5ml)	RM15 (15ml)
Tube size max	13 x 80mm	17 x 120mm
Part number	RM10 (10ml)	RM25 (25ml)
Tube size max	16 x 100mm	25 x 100mm

CR4000 Ambient Centrifuge 1 litre Max



Display indicative only.

- Speed**500-15000 Rpm
(10 Rpm steps)
- Rcf max**22,000 G
- Timer**.....0-9999 Mins & hold
(30 sec steps)
- Dimensions** ...HWD 310 x 400 x 500mm
- Weight**.....31.6 Kg (without rotor)
- Power**.....309 watts
- Memory**.....10 programs
- Accel rates** ...10
- Decel rates** ...10

CR400R Refrigerated Centrifuge 1 litre Max

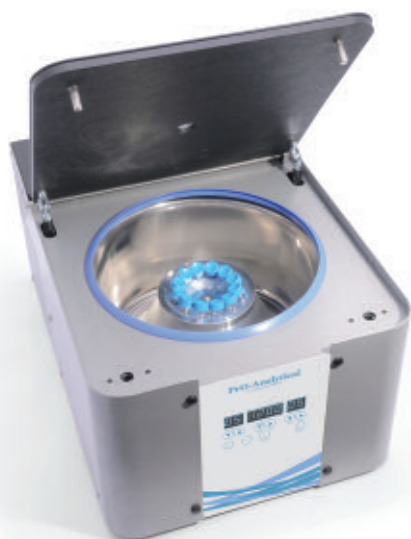

Display indicative only.

- Speed**500-15000 Rpm
(10 Rpm steps)
- Rcf max**22,000 G
- Timer**.....0-9999 Mins & hold
(30 sec steps)
- Dimensions** ...HWD 315 x 450 x 635mm
- Weight**.....62.2 Kg (without rotor)
- Power**.....448 watts
- Memory**.....10 programs
- Accel rates** ...10
- Decel rates** ...10
- Temp**-9 to +40°C PID
controlled to +/- 1°C

Microtube Rotors 15,000 Rpm

NEW

High dome sealed Polycarbonate lid included



Rotors	BRK5424 Reducers Available	BRK5436	BRK5448	BRK5494
Rotor type	24 x 2ml	36 x 0.5ml	48 x 0.2ml	4 x Pcr strips
Tube size max	11 x 50mm	8 x 30mm	6 x 40mm	8 per strip
Minimum speed	500 Rpm	500 Rpm	500 Rpm	500 Rpm
Maximum speed	15,000 Rpm	15,000 Rpm	15,000 Rpm	15,000 Rpm
Maximum Rcf (G)	22000	22000	22000	22000
Radius max cms	8.75cms	8.75cms	8.75cms	8.75cms
Sample tube angle (o)	45	45	45	45
Acceleration time (secs)	20	20	20	20
Deceleration time (secs)	20	20	20	20
Autoclaveable (frequency)	121°C (20)	121°C (20)	121°C (20)	121°C (20)

Refrigerated Centrifuges only

Minimum Temperature	4°C	4°C	4°C	4°C
---------------------	-----	-----	-----	-----

At maximum speed (relative to room temperature at 23°C)

Adaptors available - see page 19

Swing out rotors



Rotors	BRK5510	BRK5508L	BRK5530
Buckets	B5250 (set 4 required)	Complete with buckets	
Sealed Lids	B5419	N/A	
Rotor type	4 x 250ml	8 x 15ml	4 x microtitor plate
Tube size max	62 x 110mm	17 x 125mm	85 x 130mm
Minimum speed	500 Rpm	500 Rpm	500 Rpm
Maximum speed	4,000 Rpm	4,000 Rpm	3,000 Rpm
Maximum Rcf (G)	2600	2600	1250
Radius max cms	14.6	14.6	12.5
Sample tube angle (o)	0	0	0
Acceleration time (secs)	25	20	25
Deceleration time (secs)	25	20	25
Autoclaveable (frequency)	121°C (20)	121°C (20)	121°C (20)

Refrigerated Centrifuges only

Minimum Temperature	4°C	4°C
---------------------	-----	-----

At maximum speed (relative to room temperature at 23°C)

Rotors 6000 Rpm



Rotors	BRK5324	BRK5308	BRK5100
Rotor type	24 x 15ml	8 x 50ml	6 x 100ml
Tube size max	17 x 120mm	30 x 120mm	45 x 125mm
Minimum speed	500 Rpm	500 Rpm	500 Rpm
Maximum speed	6,000 Rpm	6,000 Rpm	6,000 Rpm
Maximum Rcf (G)	4800	4800	4800
Radius max cms	12	12	12
Sample tube angle (°)	30	30	30
Acceleration time (secs)	35	35	35
Deceleration time (secs)	35	35	35
Autoclaveable (frequency)	121°C (20)	121°C (20)	121°C (20)

Refrigerated Centrifuges only

Minimum Temperature	4°C	4°C	4°C
At maximum speed (relative to room temperature at 23°C)			

Reducers

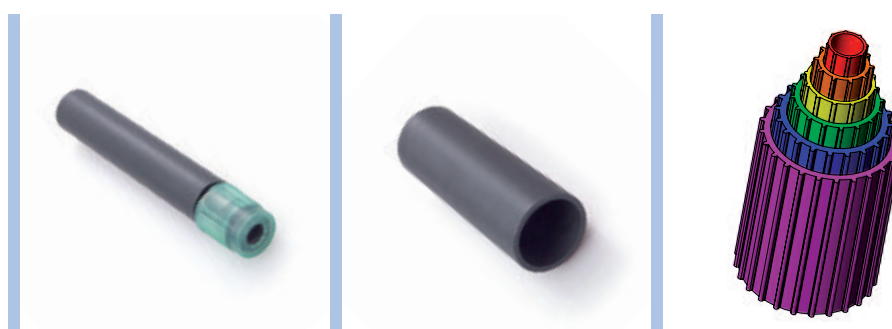

Rotor	BRK5324	BRK5308	BRK5100
Part number	RM05 (5ml)	RM15 (15ml)	RL10 (10ml)
Tube size max	13 x 80mm	17 x 120mm	16 x 100mm
Part number	RM10 (10ml)	RM25 (25ml)	RL25 (25ml)
Tube size max	16 x 100mm	25 x 100mm	25 x 100mm
Part number			RL50 (50ml)
Tube size max			35 x 115mm
Part number			RL85 (85ml)
Tube size max			39 x 115mm

2014 Refrigerated Centrifuges temperature control

At Centurion, we have taken temperature control seriously. We keep the refrigeration unit in the refrigerated centrifuges running constantly, as this not only gives the compressor a longer and reliable life, but stops the constant surges of power. Due to the fact that the refrigeration unit is running constantly it is quite usual to see ice in the chamber even at above 0°C temperatures.

For 2014, a new larger, yet more efficient CFC free compressor and lower power needs.

To maintain the temperature, we have a highly efficient compressor bypass solenoid valve, where we pulse heat via a highly accurate controller system (PID controller, which calculates and manages the temperature). By running both in conjunction with each other gives better overall temperature control, achieving the desired set temperature.

Imagine using a shower: you turn on the both the cold and hot water, adjusting to suit your desired temperature. You would not want to use one where you had to stand under the cold water, then the hot, then the cold in order to regulate the temperature.

Please see the graph that compares our system to another brand leader.

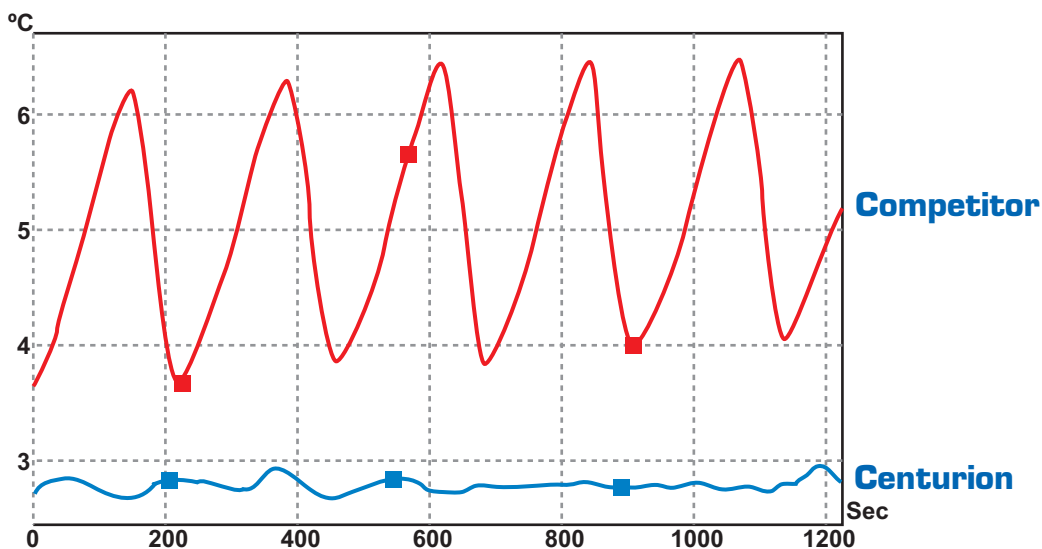

Centurion has a set temperature of 3°C, and our competitor of 4°C. This allows us to separate the target areas, to show how each machine regulates the temperature. Both refrigeration units use the same air probes, temperature units, and have the probes set at the same distance from the rotor, and finally, the correct vertical distance to the optimum the tube area.

But as you can see, we control to 0.3°C, whereas our competitor controls it to 3°C. The Centurion's control is unsurpassed, and our competitor's, which all use the same method of turning the compressor on and off, is shown to have very poor control.

Having the temperature being so controlled means that the Centurion's power usage is less, and the compressor lasts longer. This system has been in use for over 15 years, so we do know the longevity of our products. Require complete accuracy with your samples? Purchase a Centurion Centrifuge for total peace of mind. Tried, tested and proven as one of the most accurate systems in the market place.

CR7000 Ambient Centrifuge 3 Litre

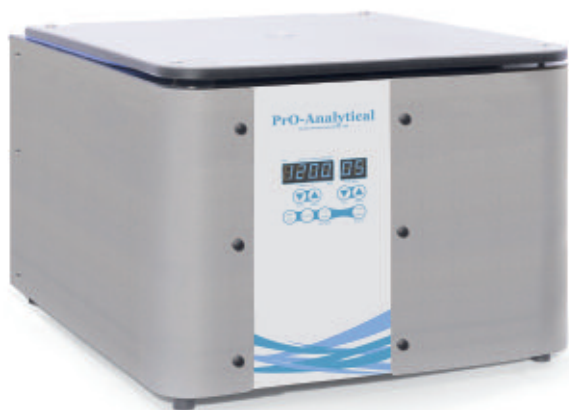

Display indicative only.

- Speed**500 - 15000 Rpm
(10 Rpm steps)
- Rcf max**22,000 G
- Timer**.....0-9999 Mins & hold
(30 sec steps)
- Dimensions** ...HWD 375 x 600 x 630mm
- Weight**.....63.5 Kg (without rotor)
- Power**.....750 watts
- Memory**.....10 programs
- Accel rates** ...10
- Decel rates** ...10

CR7000R Refrigerated Centrifuge 3 Litre



Display indicative only.

- Speed**500 - 15000 Rpm
(10 Rpm steps)
- Rcf max**22,000 G
- Timer**.....0-99 Mins & hold
(30 sec steps)
- Dimensions** ...HWD 410 x 998 x 630mm
- Weight**.....120 Kg (without rotor)
- Power**.....1200 watts
- Memory**.....10 programs
- Accel rates** ...10
- Decel rates** ...10
- Temp**-9 to +40°C PID
controlled to +/- 1°C

Microtube Rotors 15,000 Rpm

NEW

High dome sealed Polycarbonate lid included

Part number



BRK5424 BRK5436 BRK5448 BRK5494

Rotor type	24 x 2ml	36 x 0.5ml	48 x 0.2ml	4 x Pcr strips
Tube size max	11 x 50mm	8 x 30mm	6 x 40mm	8 per strip
Minimum speed	500 Rpm	500 Rpm	500 Rpm	500 Rpm
Maximum speed	15,000 Rpm	15,000 Rpm	15,000 Rpm	15,000 Rpm
Maximum Rcf (G)	22000	22000	22000	22000
Radius max cms	8.75cms	8.75cms	8.75cms	8.75cms
Sample tube angle (o)	45	45	45	45
Acceleration time (secs)	20	20	20	20
Deceleration time (secs)	20	20	20	20
Autoclaveable (frequency)	121°C (20)	121°C (20)	121°C (20)	121°C (20)

Refrigerated Centrifuges only

Minimum Temperature **4°C** 4°C 4°C 4°C

At maximum speed (relative to room temperature at 23°C)

Reducers



Rotor	BRK5424
Part number - Pack 24	RS04 (0.2 - 0.4ml)
Tube size max	6 x 30mm
Part number - Pack 24	RS05 (0.5ml)
Tube size max	8 x 30mm

Swing out rotors

Adaptors available see page 19



Part number	BRK5553
Buckets	B3000 set 4 (Required)
Rotor type	4 x 750ml
Tube size max	98 x 170mm
Minimum speed	500 Rpm
Maximum speed	4,000 Rpm
Maximum Rcf (G)	3600
Radius max cms	20.15
Sample tube angle (o)	0
Acceleration time (secs)	45
Deceleration time (secs)	45
Autoclaveable (frequency)	121°C (20)

Sealed lids available Part Nos B5319 set 4

Refrigerated Centrifuges only

Minimum Temperature **4°C**

At maximum speed (relative to room temperature at 23°C)

Rotors 6000 Rpm



	BRK5324	BRK5308	BRK5100
Part number			
Rotor type	24 x 15ml	8 x 50ml	6 x 100ml
Tube size max	17 x 120mm	30 x 120mm	45 x 125mm
Minimum speed	500 Rpm	500 Rpm	500 Rpm
Maximum speed	6,000 Rpm	6,000 Rpm	6,000 Rpm
Maximum Rcf (G)	4800	4800	4800
Radius max cms	12	12	12
Sample tube angle (°)	30	30	30
Acceleration time (secs)	35	35	35
Deceleration time (secs)	35	35	35
Autoclaveable (frequency)	121°C (20)	121°C (20)	121°C (20)







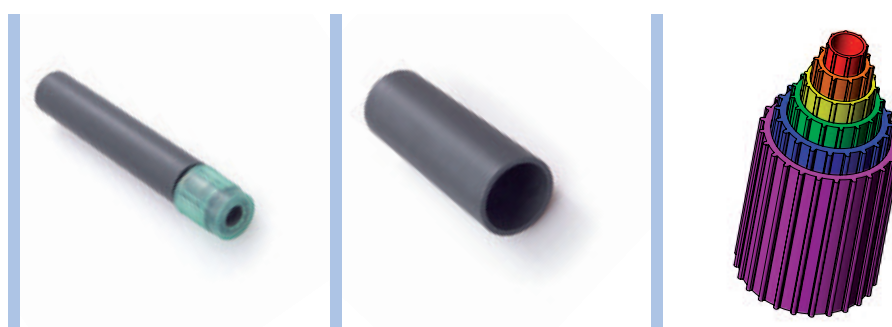

Refrigerated Centrifuges only

Minimum Temperature	4°C	4°C	4°C
At maximum speed (relative to room temperature at 23°C)			

Reducers

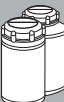

	BRK5324	BRK5308	BRK5100
Rotor			
Part number	RM05 (5ml)	RM15 (15ml)	RL10 (10ml)
Tube size max	13 x 80mm	17 x 120mm	16 x 100mm
Part number	RM10 (10ml)	RM25 (25ml)	RL25 (25ml)
Tube size max	16 x 100mm	25 x 100mm	25 x 100mm
Part number			RL50 (50ml)
Tube size max			35 x 115mm
Part number			RL85 (85ml)
Tube size max			39 x 115mm

Adaptors for Swing out rotors				Adaptors		Adaptors		Adaptors		
Tube type	Shape	Capacity	Size	To fit rotor BRK5505	To fit rotor BRK5510	To fit rotor BRK5510	To fit rotor BRK5510	To fit rotor BRK5553	To fit rotor BRK5553	
			WxH (mm)	Part nos	Nos of tubes per rotor	Need buckets	Nos of tubes per rotor	Need buckets	Nos of tubes per rotor	
	Micro with cap	point	0.5ml	8x20	AM505	36	AM605	40	AM805	120
	Micro with cap	point	1.5ml	11x38	AM520	24	AM620	28	AM820	84
	Micro with cap	point	2.0ml	11x38	AM520	24	AM620	28	AM820	84
	Micro with cap	point	0.2ml	6x20	AM502	36	AM602	48	AM802	168
	Micro with cap	point	0.4ml	6x30	AM504	36	AM604	48	AM804	168
	Plain No cap	round	1ml	6x45	AR501	36	AR601	48	AR801	168
	Plain No cap	round	3ml	10x60	AR503	28	AR603	32	AR803	96
	Plain No cap	round	5ml	12x75	AR505*	28	AR605	32	AR805	96
	Plain No cap	round	6ml	12x82	AR505*	28	AR605	32	AR805	96
	Plain No cap	round	7ml	12x100	AR507*	28	AR607*	32	AR807	96
	Plain No cap	round	9/10ml	14x100	AR509*	24	AR609*	28	AR809	84
	Plain No cap	round	15ml	17x100	AR515*	8	AR615*	28	AR815	52
	Plain No cap	round	25ml	24x100	AR525*	8	AR625	12	AR825	28
	Plain No cap	round	50ml	34x100	AR550*	4	AR650	4	AR850	16
	Plain No cap	round	100ml	45x100	AR5100*	4	AR6100	4	AR8100	8
	Plain No cap	round	150ml	52x100	See K241/R		AR6150	4	AR8150	4
	Plain No cap	round	250ml	62x100	See K241/R		BUCKET	4	AR8250	4
	Falcon with cap	Point	15ml	17x120	AF515*	8	AF615*	16	AF815	48
	Falcon with cap	Point	50ml	29x115	AF550*	4	AF650*	4	AF850	16
	Falcon with cap	Point	175ml	61x118	See K241/R		AF6175*	4	AF8175	4
	Falcon with cap	Point	175ml	17x120			AF614	4		
	Corning with cap*	Point	250ml	60x172	See K242/R		See K242/R		AF8250	4
	Corning with cap*	Point	500ml	98x148	See K242/R		See K242/R		AF8500	4
	Falcon with cap	Square	12ml	17x100	AFS512*	8	AFS612*	16	AFS812	48
	Falcon with cap	Square	25ml	25x90	AFS525	4	AFS625*	8	AFS825	28
	Falcon with cap	Square	30ml	25x110	AFS530	4	AFS630	8	AFS830	28
	Falcon with cap	Square	50ml	29x115	AFS550*	4	AFS650	4	AFS850	20
	Falcon with cap	Square	15ml	17x120	N/A	N/A	AFS614	4	AFS815	48
	Nalgene/Oakridge	Round	10ml	16x80	AN0510*	8	AN0610	16	AN0810	48
	Nalgene/Oakridge	Round	30ml	26x95	AN0530*	4	AN0630	4	AN0830	28
	Nalgene/Oakridge	Round	50ml	29x107	AN0550*	4	AN0650	4	AN0850	24
	Nalgene/Oakridge	Round	85ml	38x106	AN0585	4	AN0685	4	AN0885	12
	Nalgene/Oakridge*	Flat	250ml	62x130	See K241/R		Buckets 5250	4	AN08250	4
	Nalgene/Oakridge*	Flat	750ml	98x153	See K243/R		See K243/R		Bucket	4
	Monovette	Square	1.1-1.4ml	8x82	AM5014	24	AM6014	40	AM8014	96
	Monovette	Square	2.7-3ml	11x82	AM503	24	AM603	40	AM803	76
	Monovette	Square	2.6-2.9ml	13x81	AM529	24	AM629	40	AM829	76
	Monovette	Square	4.5-5ml	11x108	AM503*	24	AM603*	40	AM803	76
	Monovette	Square	7.5-8.2ml	13x106	AM579*	24	AM679*	40	AM879	76
	Monovette	Square	4-5.5ml	15x92	AM550*	20	AM650	28	AM850	64
	Monovette	Square	7.5-8.2ml	15x108	AM550*	20	AM650*	28	AM850	64
	Monovette	Square	9-10.0ml	16x108	AM590*	20	AM690*	28	AM890	64
	Vacutainer	Round	1.6-5.0ml	13x75	AV516*	24	AV616	40	AV816	76
	Vacutainer	Round	4-7.0ml	13x100	AV550*	16	AV650	40	AV850	76
	Vacutainer	Round	8.5-10.0ml	16x100	AV580*	12	AV680	28	AV880	64

Note:- We cannot be held responsible if the tube manufacturers change design and/or size of the tube.

* Limited capacity with sealed bucket lids (B5419 and B5319).